

1 YEAR BAMBOO AND 2 YEAR PARTS WARRANTY AND LIMITATION OF LIABILITY

Coolaroo products are manufactured by Gale Pacific Limited ACN 082 263 778 (Gale). Gale provides the following warrant in relation to Coolaroo products ("Product"). The benefits of this warranty are in addition to any rights and remedies imposed by Australian Consumer Law, NZ Consumer Guarantees Act 1993, and state and federal legislation that cannot be excluded. Nothing in this warranty is to be interpreted as excluding, restricting or modifying any applicable legislation to the supply of goods and services which cannot be excluded, restricted or modified.

WARRANTY

Gale warrants that, subject to the exclusions and limitations below, all parts of the manufacture and assembly of the Product will be free from defects in materials and workmanship for a period of one (1) year bamboo and two (2) years parts.

If a defect appears in the Product before the end of the warranty period and Gale finds the Product to be defective in materials or workmanship, Gale will, in its sole discretion, either:

- replace or repair the Product or the defective part of the Product free of charge; or
- refund the purchase price of the Product.

Gale reserves the right to replace defective parts of the Product with parts and components of similar quality, grade and composition where an identical part or component is not available.

The warranty will not apply where:

- the Product has been altered or modified by someone other than Gale or its authorised agent;
- the alleged defect in the Product is within acceptable industry variances;
- Gale cannot establish any fault in the Product;
- the defect in the Product has arisen due to the customer's failure to install and use the Product in accordance with the instructions provided;
- the defect in the Product has arisen due to the customer's request to customise the Product;
- the Product has been subject to abnormal conditions, including environment, temperature, water, fire, humidity, pressure, stress or similar.

The warranty does not extend to:

- damage or defects caused by normal wear and tear,
- water or sun damage; or
- any other damage caused by the customer placing other equipment, furniture or material in close proximity to the Product. Gale makes no express warranties or representations other than set out in this warranty.

The repair or replacement of the Product or part of the Product is the absolute limit of Gale's liability under this express warranty.

WARRANTY CLAIMS

- Upon purchasing the Product, the customer must register their warranty by completing the Coolaroo online warranty registration at www.coolaroo.com. Alternatively, the customer can contact Coolaroo Customer Service on 1800 331 521 (AU) or 0800 555 171 (NZ) for assistance.
- If a fault covered by warranty occurs, the customer must contact Gale using the contact details provided.
- Any warranty claim must be accompanied by proof of purchase and details of the alleged defect.
- The customer must bear the cost of the transport of the Product to and from Gale or the authorised agent to make the warranty claim, and all insurance of the Product.

AUSTRALIAN CONSUMER LAW

Nothing in this agreement is intended to have the effect of contracting out of any applicable provisions of the Competition and Consumer Act 2010 or the Fair Trading Acts in each of the States and Territories of Australia, except to the extent permitted by those Acts where applicable.

This warranty is not transferable, and applies only to the initial purchaser of the installed Product.

In addition to the above warranty, Australian Consumer law and other state and territory legislation may imply warranties or conditions or impose liability on Gale in relation to the Product or its supply which cannot, or can only to a limited extent, be excluded, restricted or modified. Except for those implied warranties or conditions and such liability, and for the warranty described above:

- all warranties and conditions (whether express or implied, statutory or otherwise) relating to the Product or its supply are expressly excluded; and
- Gale will not be liable for any loss or damage suffered by any person (including the purchaser of the Product) in any way relating to or arising from the Product or its use (including loss or damage arising from the negligence of, or contributed to by, Gale).

If liability for breach by Gale of a warranty or condition or any other liability imposed on Gale by legislation which cannot be excluded may be limited, Gale's liability is limited to the extent permitted by law, and if liability may be limited in any one of a number of ways, Gale's liability is limited in any one of the permitted ways chosen by Gale in its absolute discretion.

The Purchaser acknowledges that the Purchaser does not rely on the skill or judgment of Gale as to whether or not the Products are fit for any particular purpose.

The Purchaser indemnifies Gale from every liability, loss, damage, cost or expense directly or indirectly incurred or suffered by Gale caused by or contributed to by the Purchaser's failure to:

- adequately provide or display safety markings or safety information on or with the Products;
- comply with any law about the Products or their use;
- take any reasonable precaution to bring to the attention of any potential users of the Products any dangers associated with Products;
- any negligence or breach of duty by the Purchaser or any breach by the Purchaser of these terms.

GALE
P A C I F I C

Australia Toll Free: 1800 331 521
New Zealand Toll Free: 0800 555 171
United States Ph: +1 407 772 7900
Middle East Ph: +971 4 881 7114
China Ph: +86 574 5626 8888

© Coolaroo is a registered trademark of Gale Pacific Limited
Made in China



Coolaroo®
coolaroo.com

Coolaroo®

natural
SERIES

Installation
Instructions

Congratulations on the purchase of your Coolaroo® Natural Series Bamboo Roller Shade. Please be sure to read the manual in its entirety before installing your Shade.

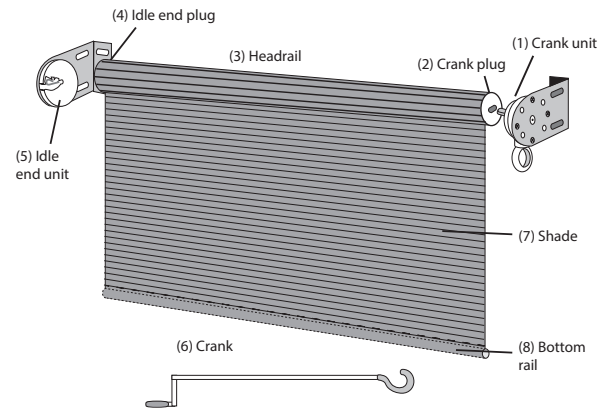

PARTS LIST		QTY
1	Crank unit	1
2	Crank plug	1
3	Headrail	1
4	Idle end plug	1
5	Idle end unit	1
6	Crank	1
7	Bamboo Shade	1
8	Bottom rail	1

Bamboo Slat Types



Match stick

ADDITIONAL TOOLS NEEDED

Drill with 3/16 in. bit
Level
Tape measure
Pencil



20 minute set up
(approximate time)

MEASUREMENT GUIDE

PRODUCT WIDTH	48 in. (122 cm)	72 in. (183 cm)	96 in. (244 cm)
MATERIAL WIDTH	45 in. (115 cm)	69 in. (175 cm)	93 in. (236 cm)
OVERALL WIDTH BRACKET-TO-BRACKET	48 in. (122 cm)	72 in. (183 cm)	96 in. (244 cm)

Fig. 1

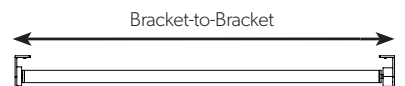

1 INSTALL BRACKETS

- A. Identify the Bracket-to-Bracket position of your Shade (**Fig. 1**).
- B. Use the center of the screw holes to allow for movement if necessary to provide a snug fit. Crank unit bracket will be on the right side, and the Idle end unit bracket should be on the left side; they cannot be interchanged (**Fig. 2**).

NOTE: Do not tighten screws completely yet.

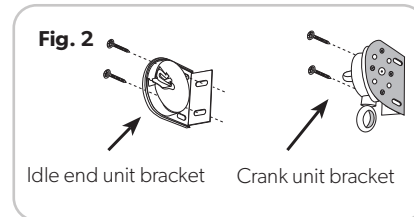

i Retract your exterior shade when not in use, or before strong storms, to prevent damage.

MAINTENANCE: Your Natural Series Bamboo Roller Shade has been made of the finest materials and, when properly cared for, will provide years of shade and privacy. Call us for missing parts or mechanical problems. Do not store Shade wet. In moist areas, roll Shade down frequently to air dry.

CAUTION: Use of solvents or abrasive cleaners may damage the Bamboo and will void your warranty. Do not use bleach or chlorine.

DISCLAIMER: Natural products like bamboo have a natural character and may have subtle colour differences. Coolaroo Bamboo matchstick is dipped to help protect its beautiful colour and appearance, however prolonged exposure to sun may cause gradual colour change.

2 ATTACHING THE SHADE

- A. Insert the Crank plug into the Crank unit (**Fig. 3**). Then insert the Idle end plug into the Idle end unit and snap the Idle end plug securely into place (**Fig. 4**).

IMPORTANT: With the shade in place adjust the brackets so they provide a snug fit. Now go back and tighten the bracket screws completely. The screws included in your hardware kit are for use with wood only. See your retailer for mounting recommendations when attaching your Shade to any other material.

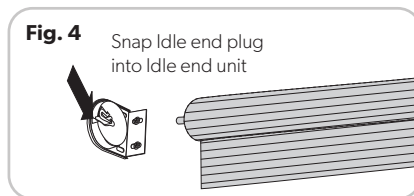
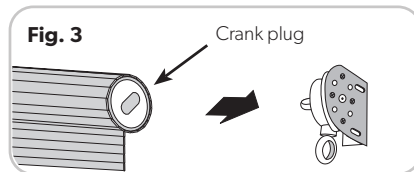

i CHANGE TO A TOP CEILING MOUNT

If you want your Shade to hang from the top (for example, the ceiling), you will need to make a simple change to your Crank unit and Idle end unit before you install your Shade.

- A. Remove the two screws from both brackets (**Fig. 5**).
- B. Turn the Crank unit 90° so the crank eyelet hangs straight down. Now turn the Idle end unit so the opening is facing away from the window (**Fig. 6**), then put the screws back in.

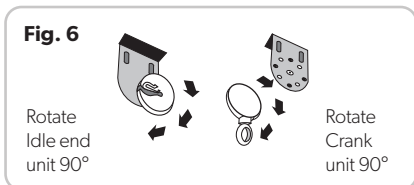
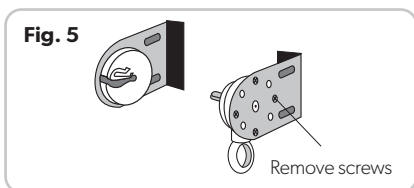

Questions or Comments? Contact us at:

GALE Pacific Limited | www.coolaroo.com | Australia Toll Free: 1800 331 521

© by GALE Pacific Limited. All rights reserved. Coolaroo® is a registered trademark of GALE Pacific Limited.