

Coolaroo Exterior Roll Up Window Shades Installation Instructions

Whilst Coolaroo Exterior Window Shades are designed primarily for use on exterior windows, they are equally at home as Drop Shades on pergolas, patios, verandahs etc. Your Coolaroo Exterior Window Shade - Roll Up comes complete with fixing accessories including fixing screws to secure the

headrail, a corrosion resistant rope cleat with fixing screws and two base rail snap-in anchor plates with fixing screws. The only tools you will require for quick and easy installation are a 1/8" drill bit, a Phillips Head screwdriver and a pencil or felt tip marker.

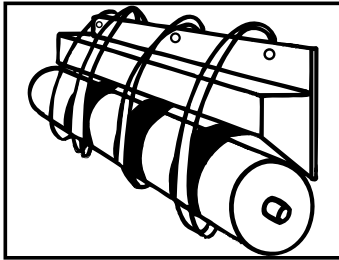

STEP 1

Once you have selected the spot for your Exterior Window Shade keep it in the rolled up position and hold the aluminium headrail in place where you would like it installed.

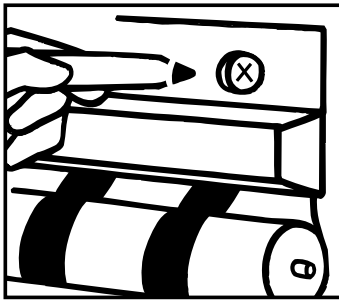

STEP 2

Mark the spots where you intend drilling holes for the fixing screws. Check the base material behind the headrail to ensure that it will accept the self-tapping screws.

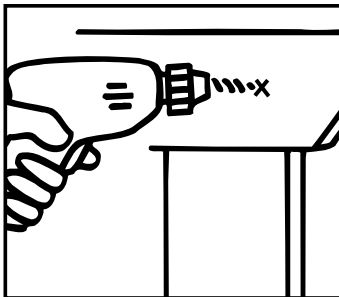

STEP 3

Remove the Exterior Window Shade and using the 1/8" drill bit, drill holes in the base material where marked.

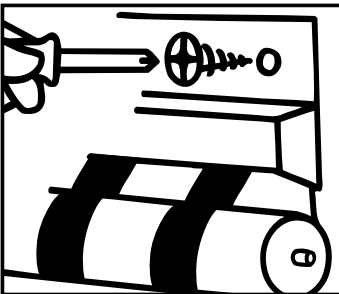

STEP 4

Reposition the Exterior Window Shade and using the Phillips Head screwdriver, fix the self-tapping screws to secure the Exterior Window Shade.

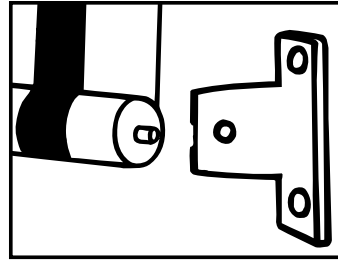

STEP 5

Release the Exterior Window Shade Fabric to fall full length. To install base anchor plates, apply light tension to the Exterior Window Shade, snap the anchor plates onto each end of the base rail and mark where the anchor plates are to be fixed with the screws provided.

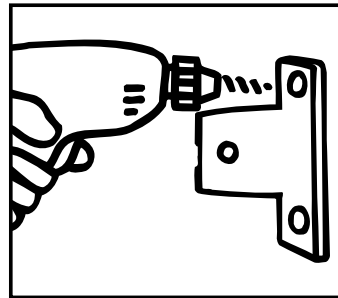

STEP 6

Using the 1/8" drill bit, drill into the base material and fix the anchor plates into place using the screws provided.

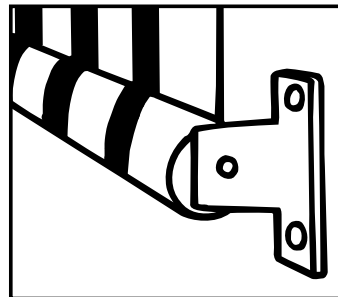

STEP 7

Lock the base rail into the anchor plates and secure the Exterior Window Shade in the fully drawn (down) position

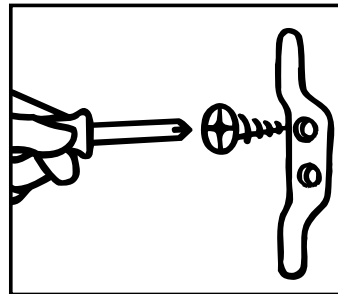

STEP 8

To attach the rope cleat, hold the cleat in position, mark holes, drill then screw the rope cleat into place using the screws provided. The cleat should be positioned so that the pull cord will be out of reach of young children. Pull the cord taut and wind it tightly around the cleat to hold the Window Shade in place

WARNING:

**Blind Cords may create a strangulation hazard for young children.
KEEP BLIND CORDS OUT OF REACH OF YOUNG CHILDREN.**



90% UV Block

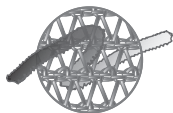

Breathes to
keep you cooler



Easy
installation



5 year fabric warranty
against UV degradation



MADE FOR LIFE

coolaroo.com

Coolaroo Exterior Roll Up Window Shades

WARNING:

It is strongly recommended that in strong wind conditions, your Exterior Window Shades are completely retracted to prevent damage to windows and your Window Shades.

Designed in Australia. Made in China.

Gale Pacific Limited

Product Warranty and Limitation of Liability

If, as a direct result of ultra-violet exposure, this product cracks, splits or tears ("defect") within 5 years after the date on which the product is purchased from Gale Pacific Limited ACN 082 263 778 ("Gale Pacific") or an authorised distributor or agent of Gale Pacific, will at its option, replace the fabric component of the product (but not any other component, such as the frame) free of charge or refund the cost of such replacement. This warranty is subject to the following conditions and limitations: **1.** All claims under this warranty must be made in writing addressed to Gale Pacific Limited, PO Box 892 Braeside, Victoria, 3195, Australia or, if the product was purchased in North America, to Gale Pacific Inc, PO Box 161268, Altamonte Springs, Florida 32716-1268, USA. All claims must be accompanied by a sample of the fabric for laboratory testing and proof of place and date of purchase of the product. **2.** Gale Pacific will not be liable for any claim made under this warranty in respect of any product in any of the following circumstances: • If the defect is contributed to or caused by any improper use of the product or usage of the product for purposes other than that for which the product was designed or intended. • If the defect occurs wholly or partly as a result of any act or omission of any person other than Gale Pacific. • If the product has been subjected to misuse, neglect, accident or abuse. • If the product is altered or modified in any way unless such modification has been approved in writing by Gale Pacific. • If the product is erected, installed or used in violation of, or in a manner that is inconsistent with, instructions or warnings furnished by Gale Pacific. **3.** This warranty does not cover: • Colour fading of the product (even if due to exposure of the product to ultra-violet rays) or a deterioration in the chemical composition of the fabric due to exposure to ultra-violet rays; or • Any damage to the product caused or contributed to by exposing the product to chemicals (including chlorine), placing the product near an open flame (including flames from a barbecue), tensioning the product beyond its tear and tensile capabilities or mechanical friction. In addition to the above warranty, the Trade Practices Act 1974 (Cth) and other state and territory legislation may imply warranties or conditions or impose liability on Gale Pacific in relation to the product or its supply which cannot, or can only to a limited extent, be excluded, restricted or modified. Except for those implied warranties or conditions and such liability, and for the warranty described above: • All warranties and conditions (whether express or implied, statutory or otherwise) relating to the product or its supply are expressly excluded; and • Gale Pacific will not be liable for any loss or damage suffered by any person (including the purchaser of the product) in any way relating to or arising from the product or its use (including loss or damage arising from the negligence of, or contributed to by, Gale Pacific). If liability for breach by Gale Pacific of a warranty or condition or any other liability imposed on Gale Pacific by legislation which cannot be excluded may be limited, Gale Pacific's liability is limited to the extent permitted by law, and if liability may be limited in any one of a number of ways, Gale Pacific's liability is limited in any one of the permitted ways chosen by Gale Pacific in its absolute discretion.



• Window Shades • Umbrellas • Shade Sails • Gazebos • Shade Fabrics •



Australia Toll Free: 1800 331 521 New Zealand Toll Free: 0800 555 171 United States Ph: +1 407 333 1038
Middle East Ph: +971 4 881 7114 Europe Ph: +49 682 1920640 China Ph: +86 574 5626 8888

coolaroo.com