



WIRE GUIDE BLIND
OUTDOOR DELUXE ROLLER



ASSEMBLY GUIDE



You will need:

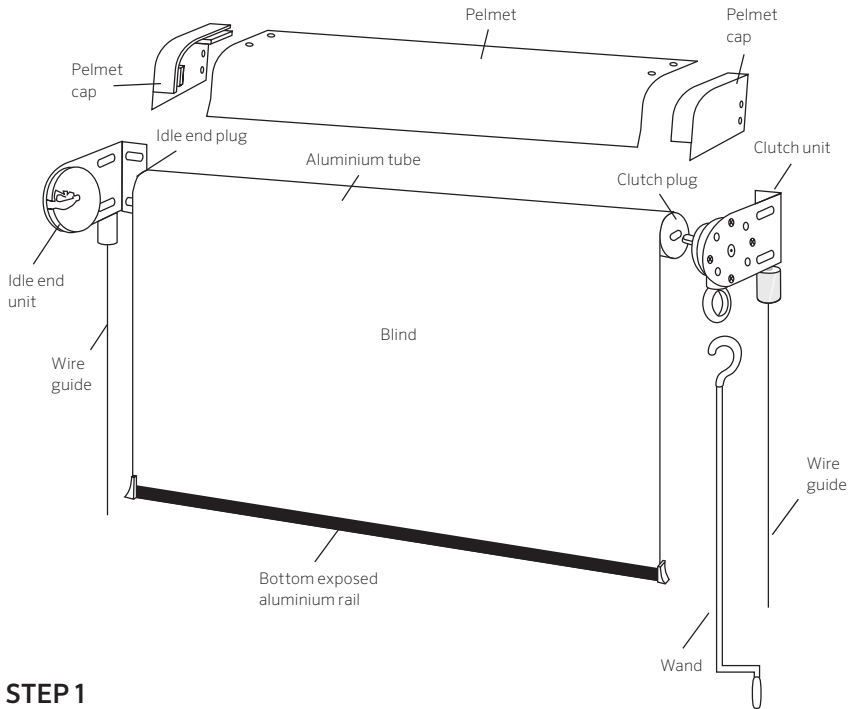

STEP 1

Take all parts out of the box and ensure they are all present

Blind

- a. Clutch unit x 1
- b. Clutch plug x 1
- c. Operating wand x 1
- d. Bottom rail x 1
- e. Blind x 1
- f. Idle end unit x 1
- g. Idle end plug x 1
- h. Aluminium tube x 1
- i. Pelmet x 1
- j. Pelmet caps x 2

Wire Guide and Fixing Components

- a. Small screws (pelmet cap) x 4
- b. Large screws with masonry plugs x 8
- c. Wire x 2
- d. Wire guide brackets x 4
- e. Adjustable wire fastener x 4
- f. Allen key x 1

You may also need:

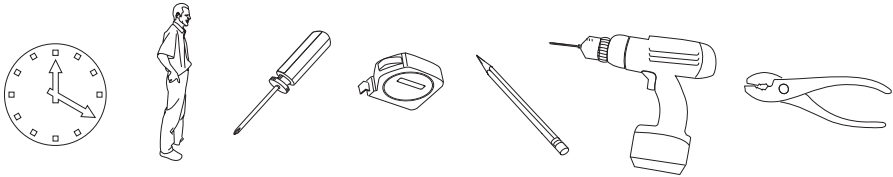

NOTE:

- a. Approximate installation time is 20 minutes.
- b. 2 people may be required.
- c. Your blind comes standard with the clutch on the right side of the blind (Fig 1) and ready to be mounted on the inside or outside of your window frame.
- d. If you want to move the clutch to the left side of the blind or you want to hang your blind from the top of the window (or ceiling), you will need to make a few simple changes to your blind before proceeding to the installation instructions. Refer to the Alternate Clutch Setup section of the manual for instructions on how to make these changes. Refer to page 2 of this manual for help identifying the various components of the blind.

CARE AND MAINTENANCE:

Your sun blind has been made of the finest materials. To clean your blind, simply rinse with water, scrub with soap or any non-abrasive cleaner, rinse and allow to dry. Do not store blind wet. In moist areas, roll blind down frequently to air dry.

WARNING:

It is strongly recommended that in strong wind conditions, your exterior window blind is completely retracted to prevent damage to windows and your window blind.

BLIND ASSEMBLY

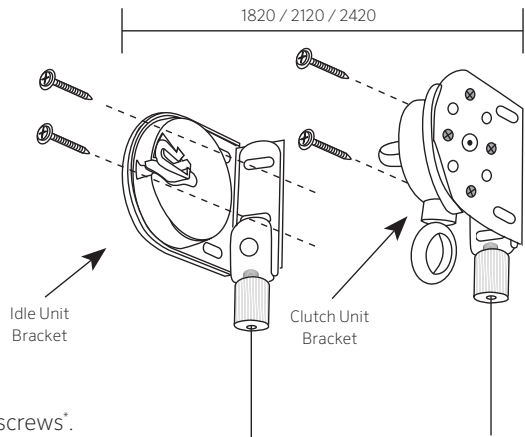

Fig 1

1. MARK THE HOLES

- a. Determine the placement of your screws*.

* When installing the top mount brackets, keep the distance between two holes at below dimensions:

- 1800mm blind = 1820mm distance
- 2100mm blind = 2120mm distance
- 2400mm blind = 2420mm distance

2. INSTALL BRACKETS

- a. Install the clutch and idle end brackets (Fig 2 & 3).
the clutch unit bracket will be on the right side,
and the idle end unit bracket should be on the left
for standard installation.

- b. Do not tighten screws completely yet.

* Be sure to fit the top wire guide brackets at the same time (as pictured). The wire guide top anchor brackets share the same 4 holes. Ensure wire guide bracket anchor is pointing down.

NOTE: Use masonry plugs if installing directly into concrete/brick wall. Do not install directly into mortar between bricks.

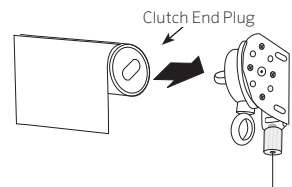

Fig 2

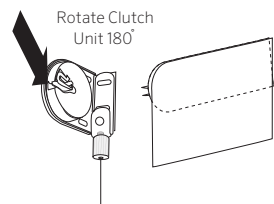

Fig 3

3. INSTALL THE BLIND

- a. Insert the clutch plug into the clutch unit (Fig 3).
- b. Insert the idle end plug into the idle end unit, and snap the idle end plug securely into place (Fig 3).
- c. With the blind in place, adjust the brackets so they fit snugly on each end of the blind.
- d. Now go back and tighten the bracket screws completely.
- e. Remove blind (only) and follow instructions on *Wire Guide System Assembly* (page 14).

ALTERNATIVE CLUTCH SETUP

Your blind will require a non-standard installation if you are changing the clutch to the left side of the blind, or if you are mounting your blind from the top/ceiling.

CHANGING TO A LEFT-HAND CLUTCH CONTROL

- a. If you want your clutch to be on the left side of your blind, you will need to make a simple change to your clutch unit before you install your blind. To make this change, remove the four screws (Fig 4).
- b. Turn the clutch unit 180 degrees so the wand eyelet can now hang down from the left side (Fig 5). Put the screws back in, and tighten. No change is needed to the idle end unit, it works for right and left mounts. Pull out both end plugs from the tube and switch them (Fig 6).

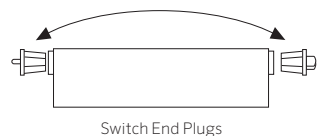
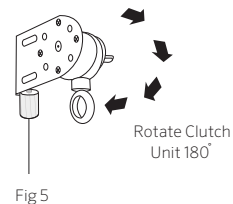
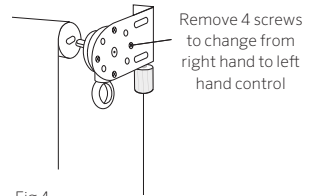

PELMET ASSEMBLY

NOTE: The pelmet and its brackets must be installed a certain way. In addition, there is a right pelmet bracket and left pelmet bracket; they cannot be interchanged. Please refer to Fig. 1 for an illustration of how the pelmet and its brackets should be installed. Please refer to page 2 of this manual for help identifying the various components of the blind.

STANDARD WALL MOUNT

NOTE: Only install your pelmet after you have installed your blind.

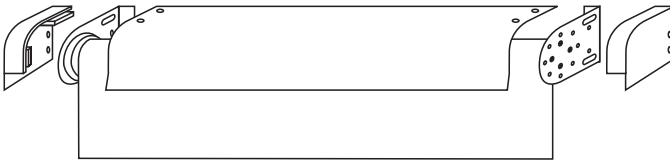
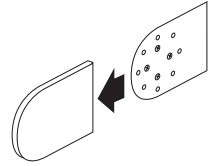

Fig 1

REMOVE BRACKET COVERS (IF INSTALLED)

- a. Slide off the blind bracket covers if installed.
You will not be using your bracket covers.



ATTACH THE RIGHT PELMET BRACKET

- a. Screw the RIGHT pelmet bracket into place.

NOTE: Refer to Fig 1 for help identifying which bracket goes on which side.

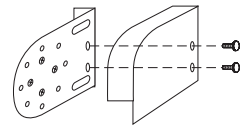

INSERT THE RIGHT SIDE OF PELMET INTO PELMET BRACKET

- a. Slide the back corner of the pelmet in between the lip of the top of the pelmet bracket.
- b. Start sliding pelmet into place, moving towards the curve.
- c. Use a flathead screwdriver to open the slot on the underside of the pelmet bracket to wedge the front (curved portion) of the pelmet into place.

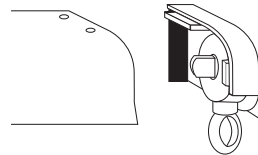

INSTALL THE LEFT SIDE OF PELMET

- a. Slide the pelmet (while attached to the left pelmet bracket) over the left mounting bracket of the blind. Screw bracket into place.

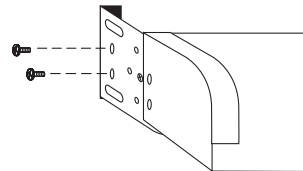

INSIDE TOP MOUNT BRACKETS FACING DOWN / CEILING MOUNT

NOTE: You should be using these instructions only if you are installing your blind and pelmet on the inside of your window casing with the brackets facing down towards the ground. See Fig 1. If you are not using your pelmet, or you are installing your blind and pelmet differently than shown in Fig 1, these instructions do not apply to your blind.

1. PREPARE CLUTCH UNIT FOR AN INSIDE VERTICAL MOUNT

- a. Start by sliding off the bracket cover on the clutch unit if installed (Fig 2).
- b. Remove the four screws from the clutch unit.
- c. Rotate the clutch unit 90 degrees so the wand eyelet hangs straight down to the ground if the bracket were hanging from the inside mount (Fig 3).
- d. Put screws back in. You will not need the bracket covers.

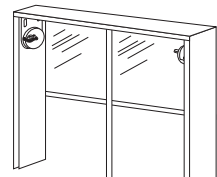

Fig 1

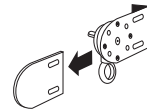

Fig 2

2. CHANGE TO A LEFT CLUTCH CONTROL (IF DESIRED)

- a. Your blind comes standard with the clutch on the right side of the blind. **NOTE: Only do this step if you want to move your clutch to the left side of the blind.**
- b. Move clutch unit to the left side of the blind, move the idle end unit to the right side of the blind.
- c. Pull out both end plugs from the tube and switch them (Fig 4).

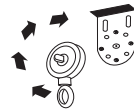
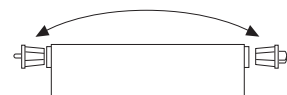

Fig 3



Switch End Plugs

Fig 4

3. MARK YOUR HOLES

- a. Mark the holes where you are going to put your screws.

4. INSTALL CLUTCH UNIT, IDLE END UNIT AND PELMET

- a. Attach pelmet to clutch unit and idle unit through holes in top of pelmet OR sandwich the pelmet between the top of window casing and the brackets*.

NOTE: Hardware to attach pelmet to clutch and idle end units is not provided.

* Install the clutch and idle end unit using screws provided (Fig 5) along with wire guide anchor brackets. See *Wire Guide System Assembly* (page 14) .

5. INSTALL BLIND

- a. Insert the clutch plug into the clutch unit (Fig 6).
- b. Then insert the idle end plug into the idle end unit, and snap the idle end securely into place (Fig 7).

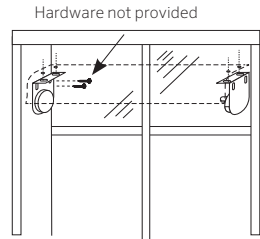

Fig 5

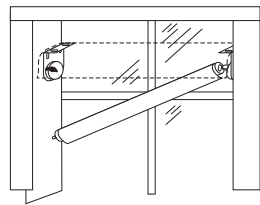

Fig 6

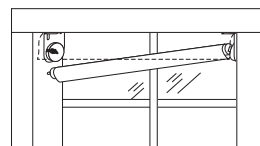

Fig 7

INSIDE SIDE MOUNT BRACKETS FACING AWAY FROM WINDOW

NOTE: You should be using these instructions only if you are installing your blind and pelmet on the inside of your window with the brackets facing away from the window (see Fig 1). If you are not using your pelmet, or you are installing your blind and pelmet differently than shown in Fig 1, these instructions do not apply to your blind.

1. REMOVE BOTH BRACKET COVERS, IF INSTALLED (FIG 2)

- a. You will not be using your bracket covers.

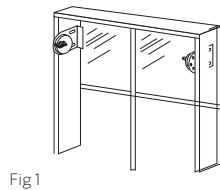

Fig 1

2. SWITCH CLUTCH TO LEFT MOUNT (IF DESIRED)

- a. Your blind comes standard with the clutch on the right side of the blind. NOTE: Only do this step if you want to move your clutch to the left side of the blind.
- b. Remove the four screws from the clutch unit.
- c. Turn the clutch unit 180 degrees so the wand eyelet can now hang down from the left side (Fig 3).
- d. Put the screws back in.
- e. Pull out both end plugs from the tube and switch them (Fig 4).

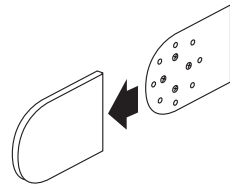

Fig 2

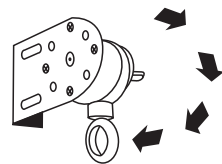

Fig 3

3. SLIDE PELMET INTO BRACKETS

- a. Slide the pelmet into the two pelmet brackets (Fig 5).
- b. Once the pelmet is in its brackets, slide entire pelmet into place.

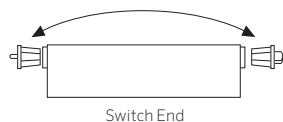

Fig 4

NOTE: Pelmet should stay in place on its own (Fig 6).

4. MARK YOUR HOLES

- a. With the pelmet and brackets in correct position, mark holes where screws will go.
- b. Take down pelmet and brackets and pre-drill holes for screws.
- c. Put pelmet and brackets back into place.



Fig 5

5. INSTALL CLUTCH UNIT AND IDLE END UNIT

- a. Install clutch unit (through holes in pelmet bracket) into pre-drilled holes.
- b. Install idle end unit (through holes in pelmet bracket) into pre-drilled holes*.

* Install top wire guide anchor brackets. See *Wire Guide System Assembly* for more information (page 14).

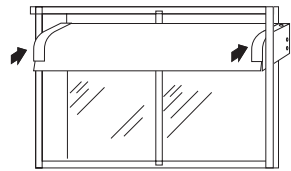

Fig 6

6. INSTALL BLIND

- a. Insert the clutch plug into the clutch unit (Fig 7).
- b. Then insert the idle end plug into the idle end unit, and snap the idle end unit securely into place (Fig 8).

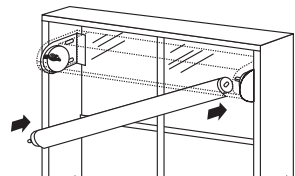

Fig 7

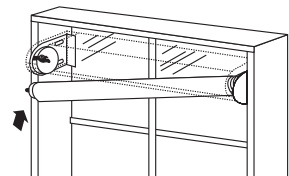

Fig 8

STANDARD TOP MOUNT BRACKETS FACING DOWN

NOTE: You should be using these instructions only if you are installing your blind and pelmet on the top of your window or ceiling. If you are not using your pelmet, or you are installing your blind and pelmet somewhere other than the top of your window (or ceiling), these instructions do not apply to your blind.

1. PREPARE BLIND FOR TOP/CEILING MOUNT

- a. Start by sliding off the bracket cover on the clutch unit if installed (Fig 2).
- b. Remove the four screws from the clutch unit.
- c. Turn the clutch unit 90 degrees so the wand eyelet hangs straight down if the clutch unit were mounted from the top (Fig 3).
- d. Put screws back in, and slide the bracket cover back on.
- e. No change is needed to the idle end unit.

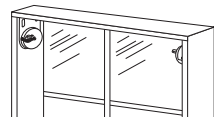

Fig 1

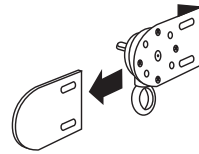

Fig 2

2. CHANGE TO A LEFT CLUTCH CONTROL (IF DESIRED)

- a. Your blind comes with the clutch on the right side of the blind. Only do this step if you want to move the clutch to the left side of the blind.
- b. Move clutch unit to the left side of the blind, move the idle end unit to the right side of the blind.
- c. Pull out both end plugs from the tube and switch them (Fig 4).

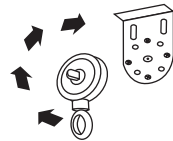

Fig 3

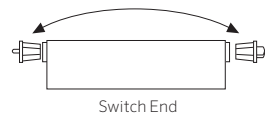

Fig 4

3. MARK YOUR HOLES

- a. Hold the pelmet up to the surface you are using for your installation.
- b. Mark the holes where you are going to put your four screws.

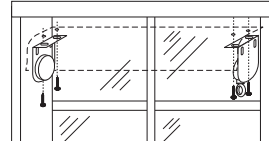

Fig 5

4. INSTALL BRACKETS AND PELMET

- a. Hold the pelmet up to the surface you are using for your installation.
- b. Install the clutch bracket and idle end bracket through the holes in the Pelmet (Fig 5). Note: You will not be using your pelmet caps*.

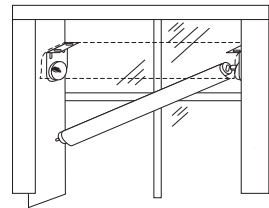

Fig 6

* Install top wire guide anchor brackets. See *Wire Guide System Assembly* for more information (page 14).

5. INSTALL THE BLIND

- a. Insert the clutch plug into the clutch unit (Fig 6).
- b. Then insert the idle end plug into the idle end unit, and snap the idle end unit securely into place (Fig 7).

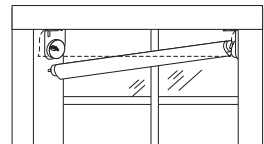

Fig 7

WIRE GUIDE SYSTEM ASSEMBLY

COMPONENTS

Take all parts out of box and ensure they are all present.

- a. Bottom brackets - small x 2
- b. Wire x 2
- c. Top brackets - large x 2
- d. Masonry plugs x 4
- e. Allen key x 1
- f. 25mm screws x 4
- g. Wire fasteners x 4

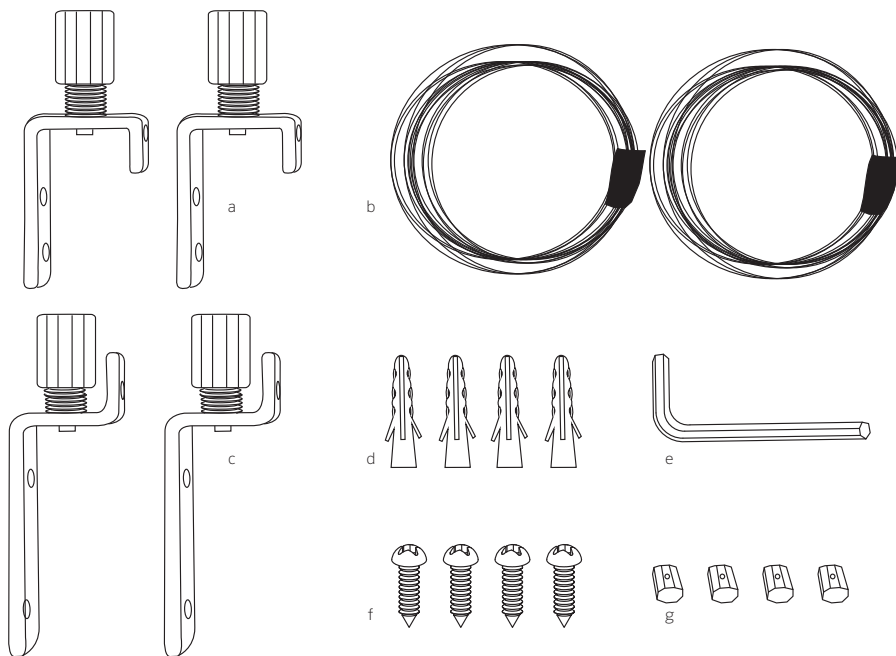

TOP BRACKETS

STEP 1

Install your top wire guide to the clutch unit and idle end unit. The wire guide anchor bracket should be pointing down as pictured. The top wire guide anchor brackets share the same holes and screws as the clutch units and the idle end unit (Fig 1).

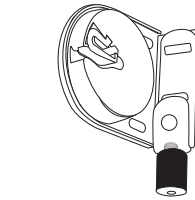

Fig 1

STEP 2

Remove screw end cap from bracket and feed wire through the screw end cap hole (Fig 2).

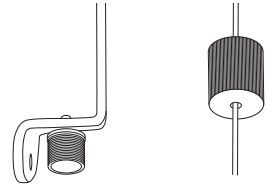

Fig 2

STEP 3

Feed wire through adjustable fastener (as pictured) and tighten with Allen key (provided). Leave approximately 3mm wire overhang (Fig 3).

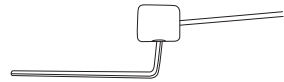

Fig 3

STEP 4

Pull wire and adjustable fastener back through the screw end cap, and screw back onto the top wire guide bracket (Fig 4).



Fig 4

STEP 5

Repeat steps 1 - 4 for other top side wire guide bracket.

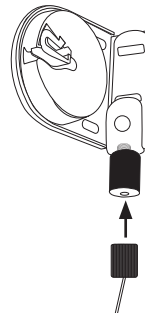
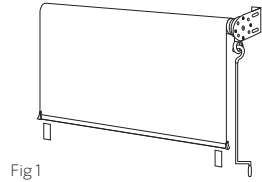

Fig 5

BOTTOM BRACKETS

STEP 1

Using the crank wand, extend roller blind out to your full desired length. The two 'bottom' wire guide brackets will sit below the base rail (as pictured in Fig 1).



NOTE: Allow for any kind of obstacles such as window winders and window sills, etc.

STEP 2

Feed wire through base rail guides (as pictured) for both sides (Fig 2).

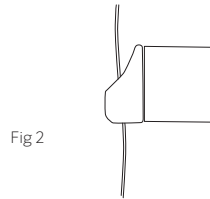

STEP 3

Remove screw end cap from bottom wire guide bracket and feed wire through (Fig 3).

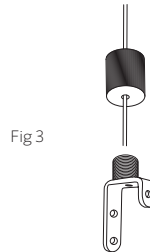

STEP 4

Feed wire through adjustable fastener (Fig 4).

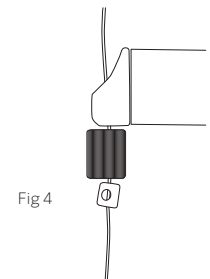

STEP 5

Tighten adjustable fastener with Allen key provided at your desired length, at least 20mm below the base rail (Fig 5 & 6).

IMPORTANT:

- a. Locate an area on the wall/floor that is suitable for the bottom bracket to be screwed into. Ensure wire guide reaches the suitable drilling point for the bottom bracket. If not, readjust the fastener to the correct length.
- b. Allow for any kind of obstacles such as window winders and window sills, etc.

STEP 6

When you are confident you have the right length, cut excess wire with pliers (as pictured). Leave approximately 3mm wire overhang (Fig 7).

STEP 7

Reattach bottom bracket by screwing the end cap back into the bracket. Pull wire guide down tight.

STEP 8

Using a pencil, mark drilling holes for the bracket installation (Fig 8).

IMPORTANT: Ensure bottom bracket is vertically aligned with the top bracket.

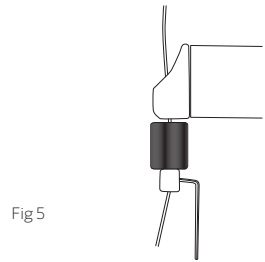

Fig 5

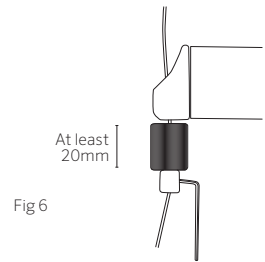

Fig 6

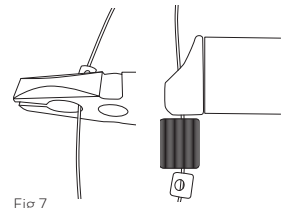

Fig 7

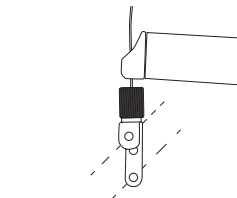

Fig 8

STEP 9

Drill holes for screws (Fig 9).

STEP 10

Screw bottom bracket into the wall/floor. Ensure bottom wire guide bracket anchor points up (Fig 8).

NOTE: Use masonry plugs if installing directly into concrete/brick wall. Do not install directly into mortar between bricks.

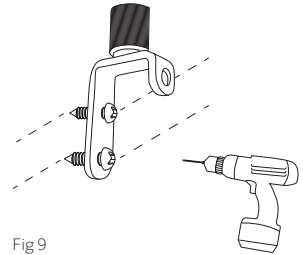

Fig 9

STEP 11

Screw cap down until wire becomes taut.

STEP 12

Repeat process for other side bottom wire guide bracket.

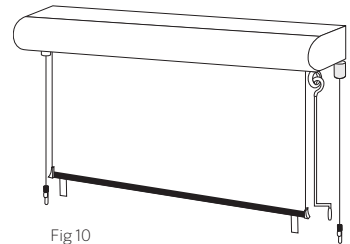

Fig 10

STEP 13

Wire guide installation is now complete, and your roller blind should move freely up and down the wire guide system, with the use of the crank operating wand (Fig 10).

CHANGE DIRECTION OF BRACKET ANCHOR POINTS (IF DESIRED)

STEP 1

Remove screw end cap (Fig 1).



Fig 1

STEP 2

Locate Philips head screw inside thread. Use a Philips head screw driver to remove screw and thread (Fig 2).

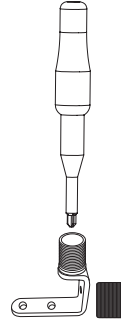

Fig 2

STEP 3

Reattach in the desired direction. Replace end cap (Fig 3).

STEP 4

Now follow instructions from *Blind Assembly* (page 4) and *Wire Guide System Assembly* (page 14) to install your blind and wire guide.

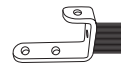

Fig 3



The best under the sun

Coolaroo is the leader in exterior fabric technology.

Our extensive range of attractive shade and landscape solutions are carefully manufactured to beautify your home and provide protection for your family and garden from the harsh sun.

coolaroo.com.au

THANK YOU FOR PURCHASING A COOLAROO PRODUCT.

To register your product go to coolaroo.com.au. The product code can be found printed above the barcode on the product packaging, alternatively you can find it on the relevant coolaroo.com.au product page.

Attention: The schematics in this manual are for assembly and operation illustration only. They may differ from the blind's actual appearance.

WARNING

Use of solvents or abrasive cleaners may damage the fabric and will void your warranty. Do not use bleach or chlorine. It is strongly recommended that in strong wind conditions, your Exterior Window Blind is completely retracted to prevent damage to windows and your Window Blind.

For help with product assembly or for any other questions you may have, contact our Customer Service Department.

Australia Toll Free: 1800 331 521
New Zealand Toll Free: 0800 555 171
United States Ph: +1 407 772 7900
Middle East Ph: +971 4 881 7114
China Ph: +86 574 5626 8888



Gale Pacific Limited
145 Woodlands Drive,
Braeside, Victoria, 3195 Australia

Coolaroo is a registered trademark of Gale Pacific Limited

